

# 20 kilometres of new urban public shoreline

International surveys in recent years have repeatedly ranked Helsinki as one of the best places in the world in which to live. Greater Helsinki is home to over a million people, representing one-fifth of the population of Finland. One of the city's biggest attractions is its classic Nordic maritime scenery.

Major changes are looming on the Helsinki horizon. Vast harbour and industrial areas have been liberated in the city centre and will be developed over the coming decades into three new districts offering a good life by the sea.

At the same time city residents will gain access to 20 kilometres of shoreline. The new city districts and seaside boulevards will bring the sea even closer to the life of Helsinki's residents.

## WELCOME TO THE FUTURE OF HELSINKI!

The **Helsinki Horizon 2030** exhibition takes place inside a sea container and presents the changes planned for the former harbour areas in Länsisatama, Kalasatama and Kruunuvuorenranta.

Aerial photography makes it easy to locate these areas in Helsinki, and scale models present the planned buildings in detail. Video clips let you experience the unique atmosphere in each of three areas.

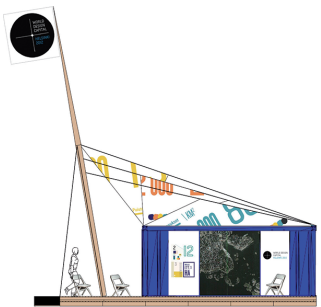

## SNEAK PREVIEW OF HELSINKI'S NEW CITY DISTRICT



City of Helsinki

Find out more about

## HELSINKI HORIZON 2030

<http://en.uuttahelsinki.fi/>

Find out more about

## THE EXHIBITION

[kaupunkiluotsi@hel.fi](mailto:kaupunkiluotsi@hel.fi)

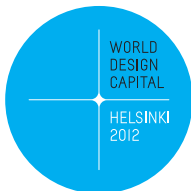





# JÄTKÄSAARI

— AN URBAN RESIDENTIAL AREA THAT HAS BEEN RECLAIMED FROM THE SEA

- Most of the land area in Jätkäsaari is land that has been reclaimed from the sea over the past hundred years.
- The distance from Jätkäsaari to the city centre is just 1.5 kilometres. The area will be served by an efficient tram network.
- A long curving park will run through the area to a swimming beach at the other end.
- The passenger harbour will continue to operate. The former harbour warehouse will be converted into a sports centre, school, youth centre and library.
- Housing for 16,000 residents and premises for 6000 workplaces will be built in Jätkäsaari.

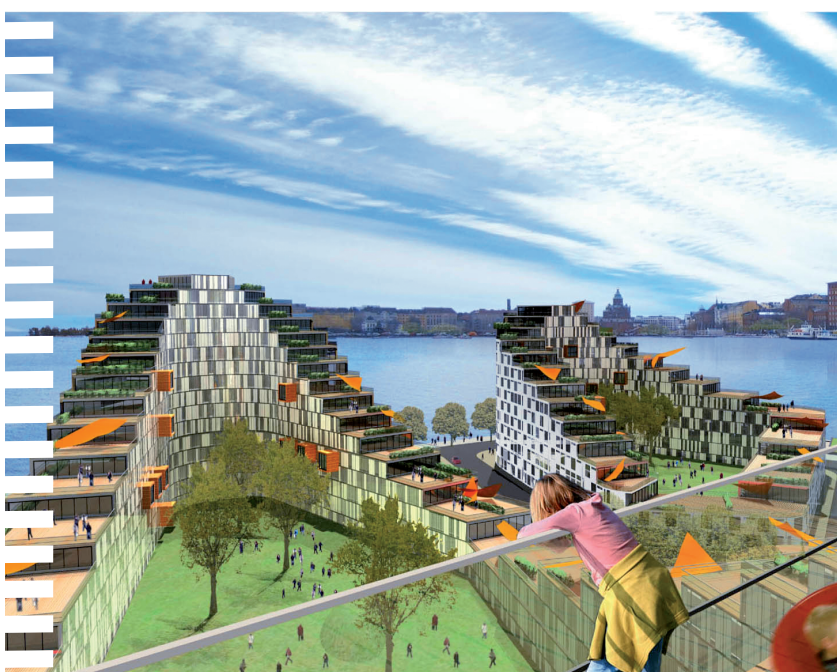

# KALASATAMA

— CULTURE ALONGSIDE THE CITY CENTRE

- The heart of Kalasatama is its metro station, around which services and a terminal for trams and buses will be located.
- The historical Suvilahti power plant has already been transformed into an important cultural centre whose activities will be further expanded.
- The Wholesale Food Market “Tukkuutori” will be transformed into a culinary shopping and restaurant complex that is open to the public.
- The shoreline will be opened to the public, a view to the sea will open up at the end of the streets, and the planned residential buildings will face the sea.
- Housing for 18,000 residents and premises for 10,000 workplaces will be built in Kalasatama.



# KRUUNUVUORENRANTA

— URBAN LIVING ON AN ISLAND

- The former oil terminal is being transformed into a residential neighbourhood in close proximity to the sea and archipelago nature.
- Kruunuvuorenranta will be connected to the city centre by three new bridges designed for use by trams, as well as pedestrians and cyclists.
- On western shore townhouses will line a pier-like seaside promenade with a view to the UNESCO World Heritage Site Suomenlinna.
- Recreational services including a high-quality swimming beach and marina will be located on the eastern shore. A long park runs across the district connecting the two shores.
- Housing for 10,000 residents and premises for 800 workplaces will be built in Kruunuvuorenranta.